

Retama Village Clubhouse New System Operation

2/11/2023

Normal State

The amplifier is on all the time. It is common for the Retama Village Audio/Visual system to play background music, usually from the PC (iHeart Radio) or a DishTV Music channel.

Operations

The system Control Center is in the Dining Area behind the Access Panel. Start here.



Here is a monitor that displays what the system is viewing, a keyboard and mouse for PC operation,



HDMI inputs for a Video Camera, a Visitor HDMI Input, and the input for the audio Mixer.

These are part of the Input Choices for the System.

1. Dish TV receiver
2. Video Camera
3. DVD Player
4. Axillary Input
5. PC

Retama Village Clubhouse New System Operation

2/11/2023



A powered USB hub attached to the PC, to be used for USB devices like disk drives and USB sticks and devices that need USB power.



Wireless microphone (note white switch behind the microphone that turns on the wireless receiver),

The batteries are normally not in the microphone and are found in front of the DVD Player.

This microphone will feed through the ceiling speaker system.

Please remove the batteries when you are done with the microphone.



DVD player.

Input Selection

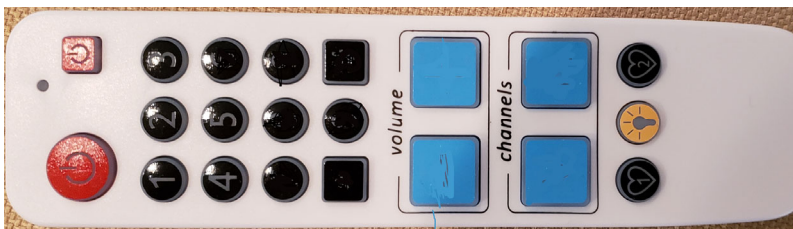

Only Buttons 1-5 are active.

Retama Village Clubhouse New System Operation

2/11/2023

The starting point to operate the Retama Village Clubhouse audio/visual system is to select the input:

1. Dish TV receiver
2. Video Camera
3. DVD Player
4. Axillary Input
5. PC

The selection is done by using the Remote labeled **Input**.

Once you have selected the desired input source, the source will appear on the monitor in the control center.

Then, depending on your input selection, tune to or select what will be displayed on that input.

1 - Dish TV receiver



If the receiver is off, power it on with the remote power button.

Using the Dish TV receiver Remote channel buttons and menu guides, select the channel you want to watch.

Ignore all the other buttons on the remote.

2 - Video Camera

Plug the HDMI cable from the video camera into the HDMI receptacle labeled **Camera**.

Retama Village Clubhouse New System Operation

2/11/2023

Turn on the camera.

3 - DVD Player



At the current time, the remote for the DVD player will only work in the Dining Area.

Turn on the DVD player located at the bottom of the Control Center and insert your DVD.

Only the power button, the button below it to power off, and the play buttons work.

4 - Axillary Input

Insert the HDMI cable from the device you want to watch into the HDMI receptacle labeled **AUX**. Typically a visitor Laptop.

5 - In House PC

Using the keyboard and mouse located in the Control center, run the application you want to view.

The PC should be logged in but if needed, the **Pin** is **2201**.

The USB hub on the bottom right of the Control Center is a powered hub and can be used for inputs to the PC as well as powering other devices.

The PC has 32 GB of memory, has a 250 GB disk attached (D:) and is loaded with Microsoft Office 365 and Open Office.

Retama Village Clubhouse New System Operation

2/11/2023

Which devices to watch.

The video devices that you can watch are:

1. Lounge TV
2. Pool Room TVs
3. The overhead screen projector.

Any, or all can be turned on and all will display the same video.

1- Lounge TV



The Power Button should be the only Remote button used. Same remote is used for all three TVs.

If the Lounge TV has been messed with, the Source button should be used to set the Input to HDMI2.

The volume should be set to mute because the sound will come through the ceiling speakers and the TV speakers will conflict with the sound.

2- Pool Room TVs



The Power Button should be the only Remote button used. The same remote is used for all three TVs.

Retama Village Clubhouse New System Operation

2/11/2023

If the either Pool Room TV has been messed with, the Source button should be used to set the Input to HDMI2.

The volume should be set to mute because the sound will come through the ceiling speakers and the TV speakers will conflict with the sound.

Western TV is not functional.

Retama Village Clubhouse New System Operation

2/11/2023

3 - The Overhead Projector



First the Screen needs to be lowered. The wall mounted control is in the closet next to the Refrigerator in the Kitchen.

Just push **UP** to raise the Screen or **Down** to lower it. The Screen will automatically run to its limits.

Using the Remote from the Control Center labeled **Projector**, turn on the Projector.

You should not change any of the Projector adjustments.

Raise the screen when you are done and turn off the Projector.

Retama Village Clubhouse New System Operation

2/11/2023

Sound Adjustment



All the sound for any of the selected inputs will come through the ceiling speakers throughout the Clubhouse.

It will be the same sound.

The volume level is set in each room by the wall mounted Volume Control in that room. Each control is labeled **Volume**.

This is a layout of the speaker Controls and the speakers they control.

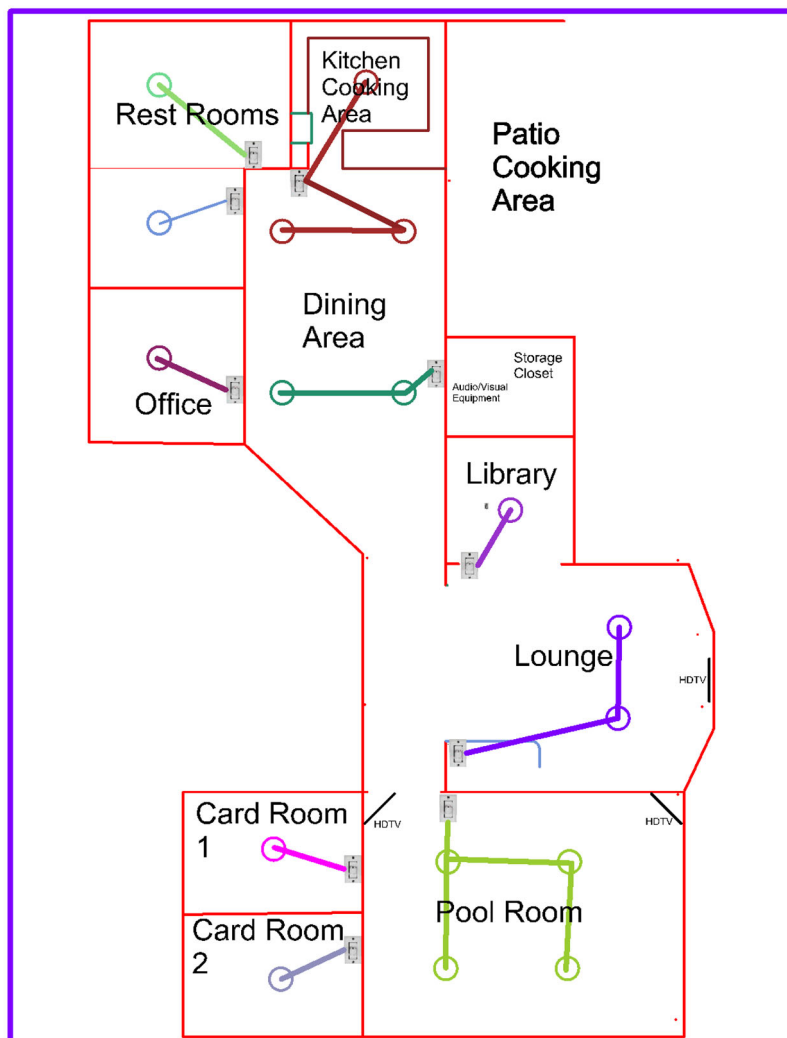

Retama Village Clubhouse New System Operation

2/11/2023



Also, all the sound for any of the selected inputs will come through the ceiling speakers throughout the Craft Building.

It will be the same sound as the Clubhouse.

The volume level is set in each room by the wall mounted Volume Control in that room. Each control is labeled **Volume**.

This is a layout of the speaker Controls and the speakers they control.

